

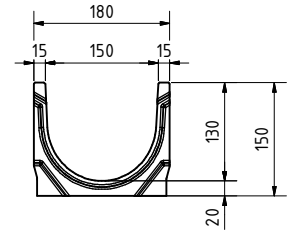

1. Rinne / Channel:

light NW150

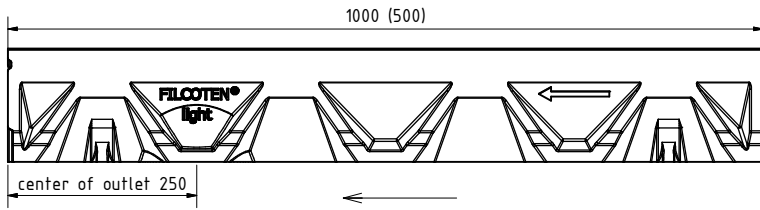

Rinne / channel - Maße / dimensions				
Typ	Höhe A height A	Höhe B height B	Länge length	BG code
0	150	150	1000	10315000
0 (0,5m)	150	150	500	10315050

Legende / explanation:	
V:	verzinkter Stahl / galvanized steel
E:	Edelstahl / stainless steel
GJS:	Gußeisen / ductile iron
H:	Holz / wood

2. Stegrost / Slotted grating:

A15kN SW8/130: V 17015200 (17015201)

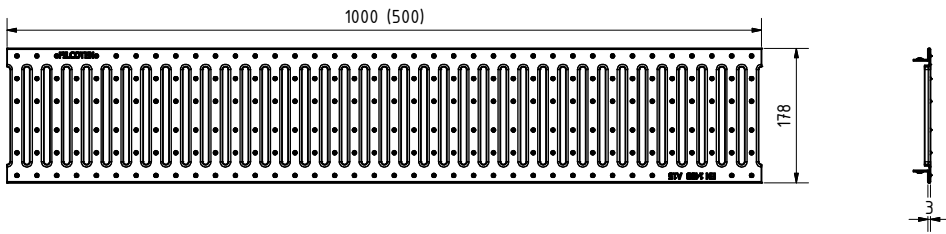

2. Gitterrost / Mesh grating:

B125kN MW30/10: V 17015210 (17015211)

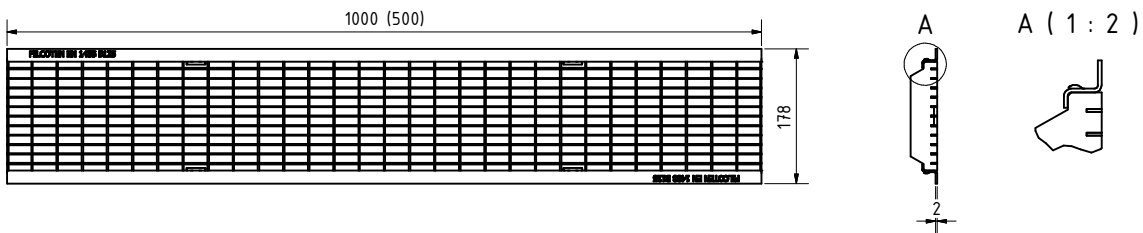

2. Gußrost / Ductil iron grating:

C250kN MW15/28: GJS 17015100

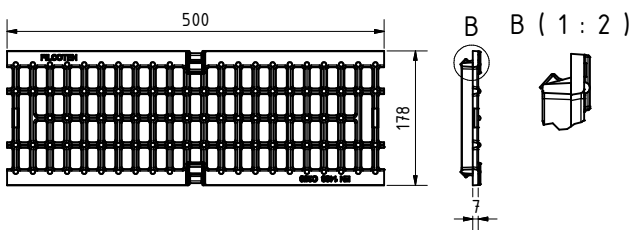

2. Schlitzaufsatz / Slot top:

C250kN SW12,5: V 17115243 (17115244), E 17115343 (17115344)

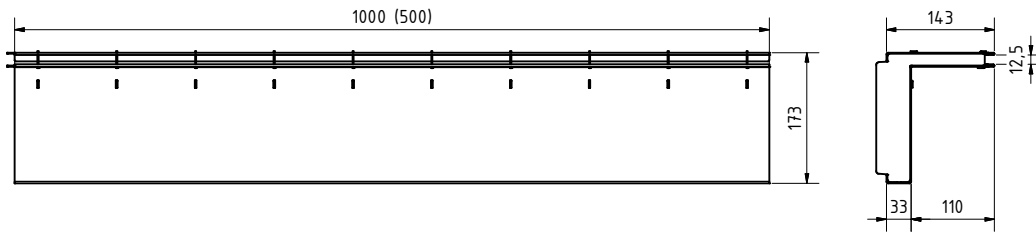

C250kN SW18: V 17115233 (17115234) , E 17115333 (17115334)

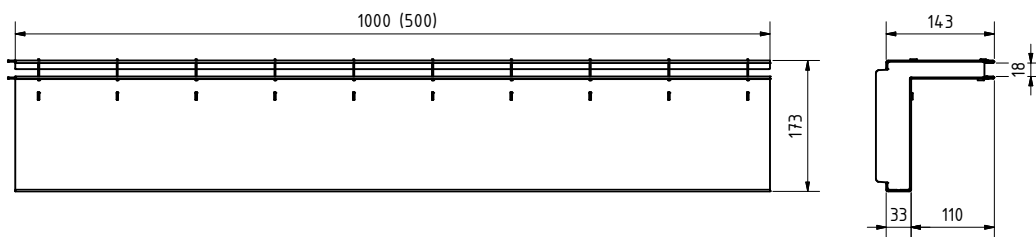

2. Revisionschacht / Maintenance unit:

C250kN SW12,5: V 17115281, E 17115381

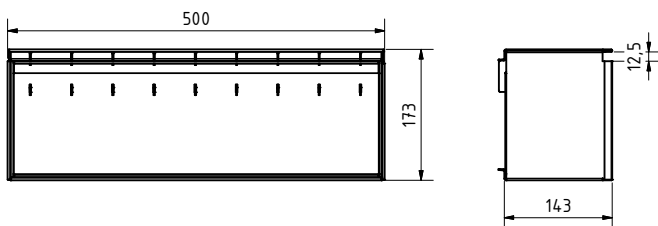

C250kN SW18: V 17115295, E 17115395

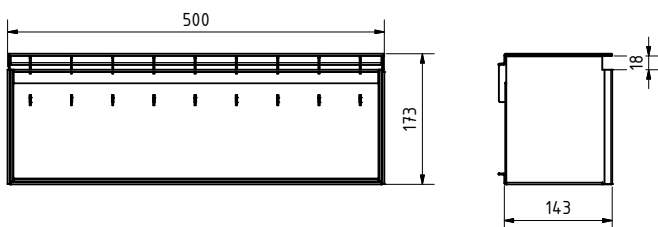

2. Schlitzeinlage / Slot inlay square-perf. 8/8:

V 37951 (37950), E 37956 (37955)

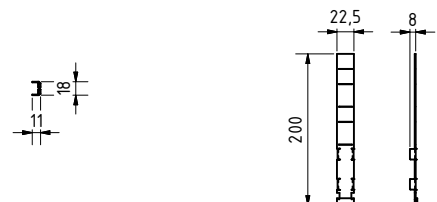
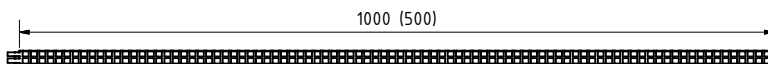

2. Bauzeitabdeckung / Construction time barrier SW 18:

H 37961

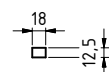
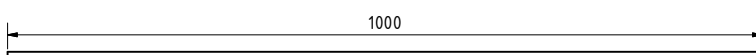

4. Stirnplatte/End cap:

V 17110280, E 17110380

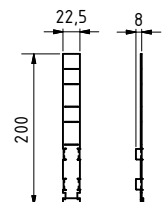

3. Sinkkasten / Sump unit:

(optional: Geruchsverschluss / Drain trap: 30057
Schlammeimer / Silt bucket: 22516)

V 10315091

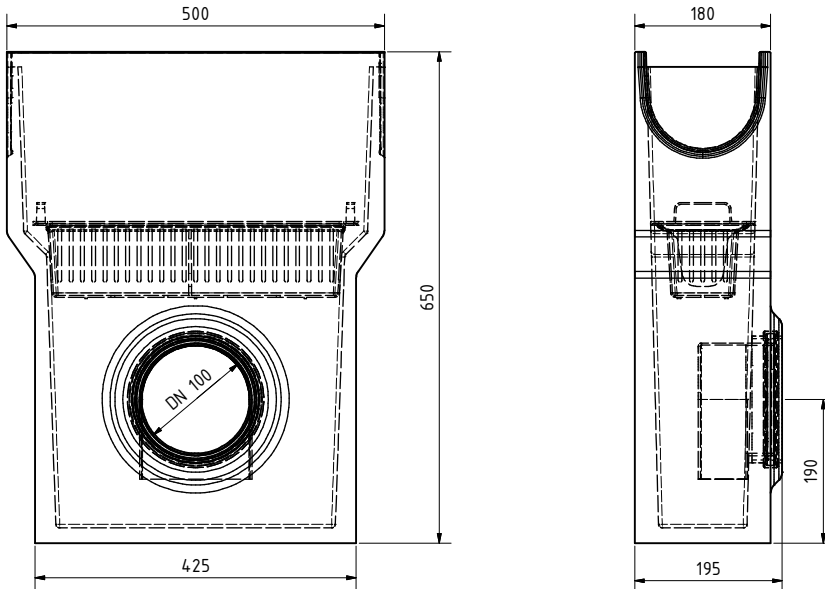

4. Stirn-/ Endplatte / End cap:

V 19015230, E 19015330

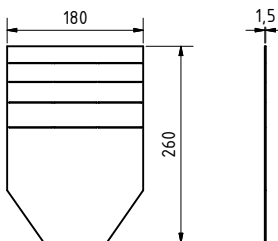

V 19015232, E 19015332

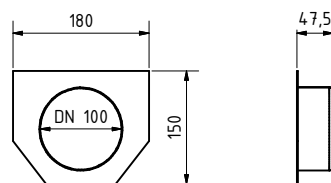

5. Patentklammer / Locking clip:

Gitterrost/ Mesh grating 32080

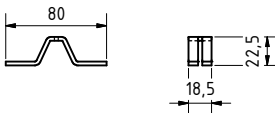

Gussmaschenrost/ ductil iron mesh grating 32067

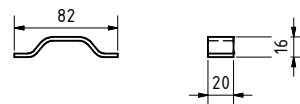

5. Halteklammer / Fixing clip:

Gussmaschenrost/ ductil iron mesh grating 32068

