

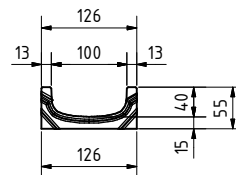

1. Rinne / Channel:

light NW100 mini 55

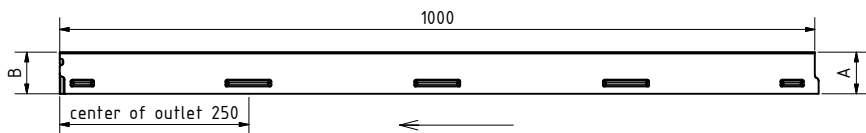

light NW100

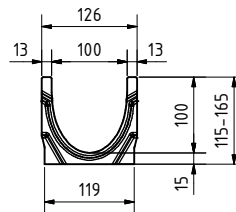
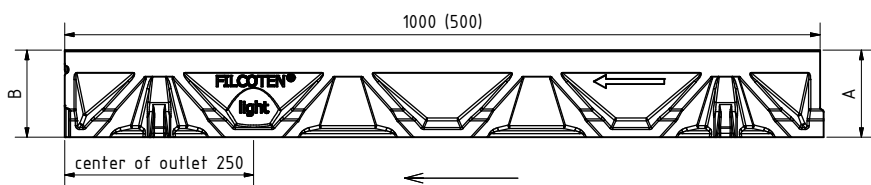

light NW100, Nr. 5-0 f. seitl. Bohrung/f. side outlet drilling

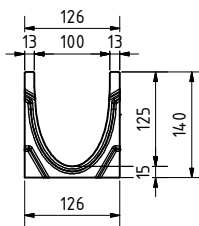
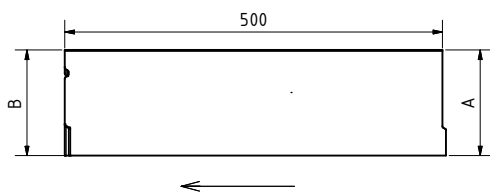

Rinne / channel - Maße / dimensions				
Typ	Höhe A height A	Höhe B height B	Länge length	BG code
mini 55	55	55	1000	10110000
0	115	115	1000	10311000
0 (0,5m)	115	115	500	10311050
1	115	120	1000	10311001
2	120	125	1000	10311002
3	125	130	1000	10311003
4	130	135	1000	10311004
5	135	140	1000	10311005
5-0	140	140	1000	10311061
5-0 (0,5m)	140	140	500	10311051
6	140	145	1000	10311006
7	145	150	1000	10311007
8	150	155	1000	10311008
9	155	160	1000	10311009
10	160	165	1000	10311010
10-0	165	165	1000	10311062

Legende / explanation:	
V:	verzinkter Stahl / galvanized steel
E:	Edelstahl / stainless steel
GJS:	Guß Eisen / ductil iron
H:	Holz / wood

2. Stegrost / Slotted grating:

A15kN: SW8/80 V 17010200 (17010201), SW5/80 E 17010300 (17010301)

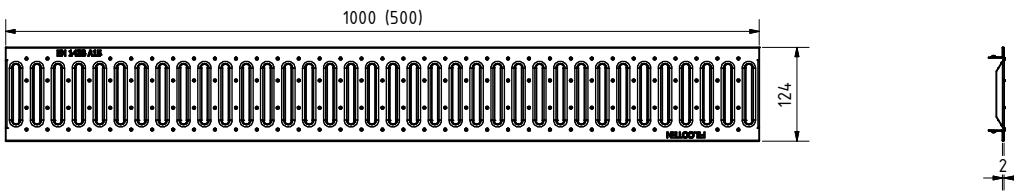

2. Gitterrost / Mesh grating:

B125kN MW30/10: V 17010210 (17010211), E 17010310 (17010311)

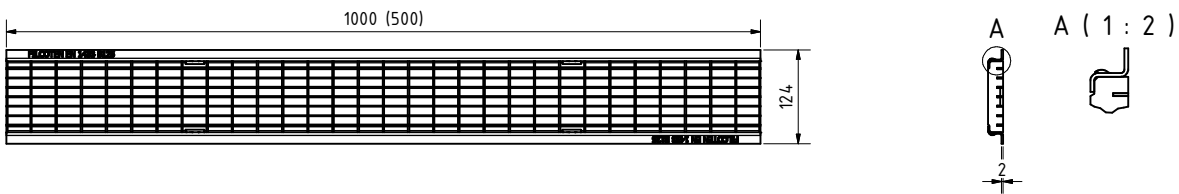

2. Gußrost / Ductil iron grating:

**C250kN MW15/25: GJS 17010100,
KTL-beschichtet / KTL-coated 17010150**

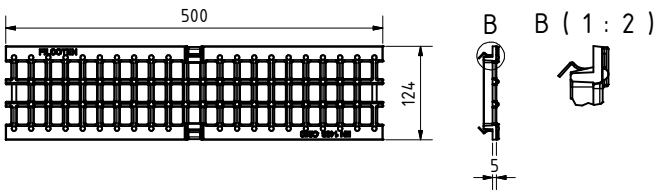



2. Schlitzaufsatz / Slot top:

C250kN SW12,5: V 17110243 (17110244), E 17110343 (17110344)

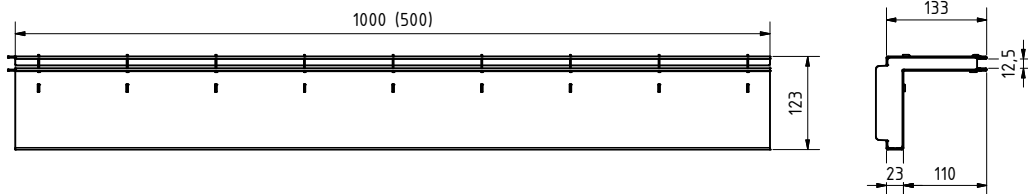

C250kN SW18: V 17110233 (17110234) , E 17110333 (17110334)

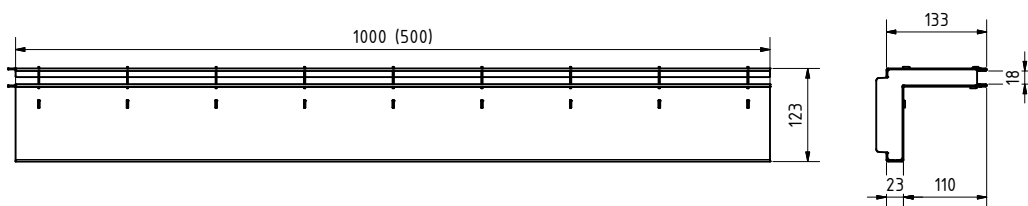

2. Revisionschacht / Maintenance unit:

C250kN SW12,5: V 17110281, E 17110381

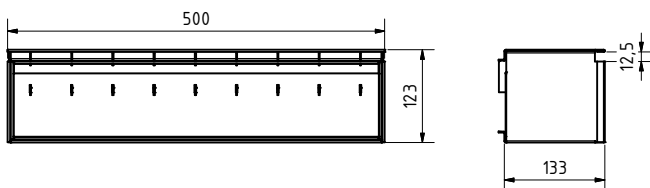

C250kN SW18: V 17110295, E 17110395

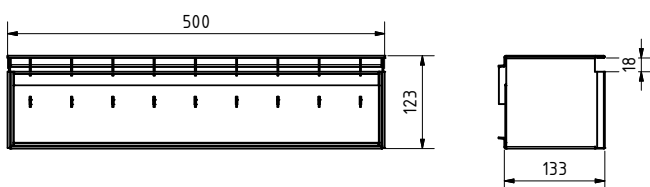

2. Schlitzeinlage / Slot inlay square-perf. 8/8:

V 37951 (37950), E 37956 (37955)

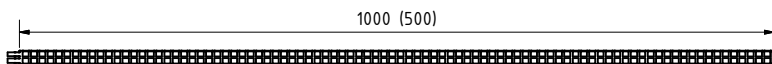

4. Stirnplatte/End cap:

V 17110280, E 17110380

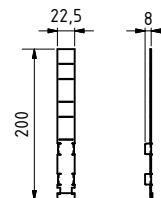

2. Bauzeitabdeckung / Construction time barrier SW 18:

H 37961

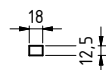
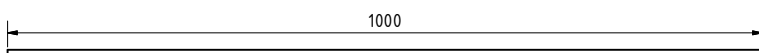



2. Schlitzaufsatz / Slot top:

B125kN SW12,5: V 17110237 (17110238), E 17110337 (17110338)

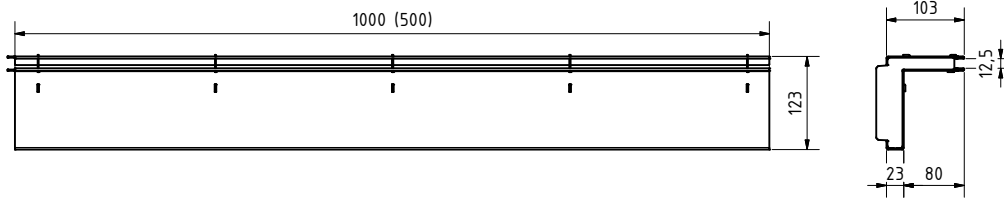

2. Revisionschacht / Maintenance unit:

B125kN SW12,5: V 17110297, E 17110397

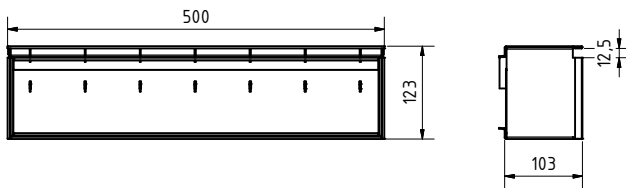

3. Sinkkasten / Sump unit:

(optional: Geruchsverschluss / Drain trap: 30056
Schlammeimer / Silt bucket: 22515)

V 10310093

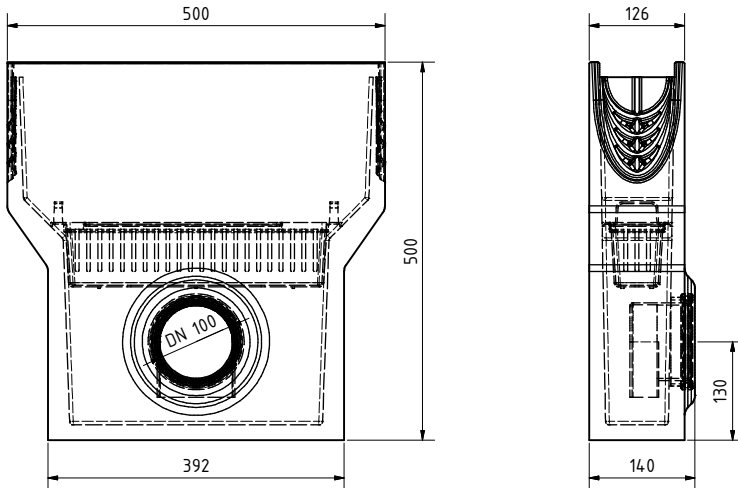

**4. Stirn-/ Endplatte
/ End cap:**

V 19010230, E 19010330

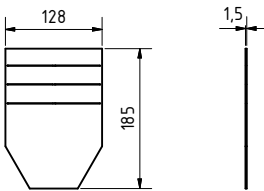

V 19010232, E 19010332

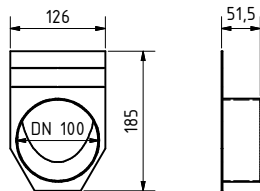

mini: V 19010200, E 19010300

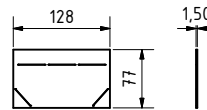

**5. Geruchsverschluss für Bodenablauf
/ Drain trap for bottom outlet:
PVC 30019**

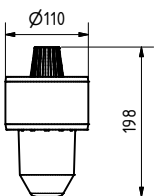

6. Halteklammer / Fixing clip:

**Gussmaschenrost/ ductil iron mesh grating
32068**



6. Patentklammer / Locking clip:

**Gitterrost/ Mesh grating
32080**

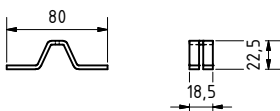

**Gussmaschenrost/ ductil iron mesh grating
32067**

